



MINIMEIS[®]

Let's get started

minimeis.com/manual



**IMPORTANT! KEEP FOR
FUTURE REFERENCE.**

It is very important to read, understand, and follow
this manual before using your MiniMeis carrier.

Important Safety Information

Read and Understand this Manual Before Use

This Getting Started manual contains important information for protecting yourself and others and preventing potential problems – please read it carefully. Failure to follow these safety instructions and precautions can lead serious injury or death.

Intended Use

The intended use of your MiniMeis G4 carrier is to transport children on your shoulders in a fun, safe, practical and comfortable way. Any other use of the carrier is prohibited and may result in serious injury or death.

WARNING

To prevent **SERIOUS INJURY** or **DEATH**:

- **NEVER** use the carrier with a child weighing less than 16 lb. (7 kg) or more than 40 lb. (18 kg).
- **NEVER** use the carrier with a child that can't sit up unaided, less than 6 months old or more than 5 years old.

Child Safety

FALL and STRANGULATION HAZARD. To prevent SERIOUS INJURY from falling or sliding out:

- **When in the carrier, your child will be in a position higher than the caregiver. Be aware of door frames, low tree branches, ceiling fans or other potential hazards in your path of travel.**
- **ALWAYS use child retention system.**
- **NEVER leave child unattended in your MiniMeis carrier.**
- **NEVER place carrier unattended on counter tops, tables, or other elevated surfaces with the child in the MiniMeis.**
- **ALWAYS bend at the knees to keep child upright. Leaning, bending over or tripping can cause you and the child to fall.**

Activity Related Hazards

- **ONLY** use your carrier when walking, sitting or standing.
- **NOT** for use during sports activities.
- **NEVER** jog, run, climb, ski, bike, ride horses, or use any motorized vehicle while using carrier.
- **NEVER** use in shower, pool, or any other location where water is present.
- **NEVER** use carrier while engaging in activities such as cooking or cleaning which involve a heat source or exposure to chemicals.
- **KEEP AWAY** from fire.
- **NEVER** use carrier when under the influence of alcohol or drugs.
- **NEVER** use carrier when balance or mobility is impaired because of exercise, drowsiness, or medical conditions.



Activity Related Hazards (continued)

- **Check on your child often. Be aware your child may suffer from the effects of the weather and sun before you do when riding in the carrier. You may need to provide water, sunscreen or a hat.**
- **Take frequent breaks to help prevent the child from becoming tired or restless in the carrier .**



Caregiver Safety



Your balance may be adversely affected by the movement of the child or your own movement.

- **NEVER use carrier with a child weighing more than 40 lb. (18 kg).**

- **ALWAYS** be careful when putting on or removing your carrier. Ask for assistance if needed to prevent injury.
- **NEVER** use your carrier as a means to transport your child in a motor vehicle. Your carrier is not intended for use as a child restraint device in a motor vehicle
- **NEVER** wear carrier while driving or riding as a passenger in a motor vehicle
- **NEVER** allow child to sleep in your Minimeis carrier.
- **NEVER** leave a child in a carrier that is not being worn
- **NEVER** use if you have shoulder, back or neck problems. If use of the carrier causes discomfort, stop use and consult your doctor.
- **NEVER** place more than one child in the carrier.
- **NEVER** wear more than one carrier at a time.

MiniMeis G4 Components (front)

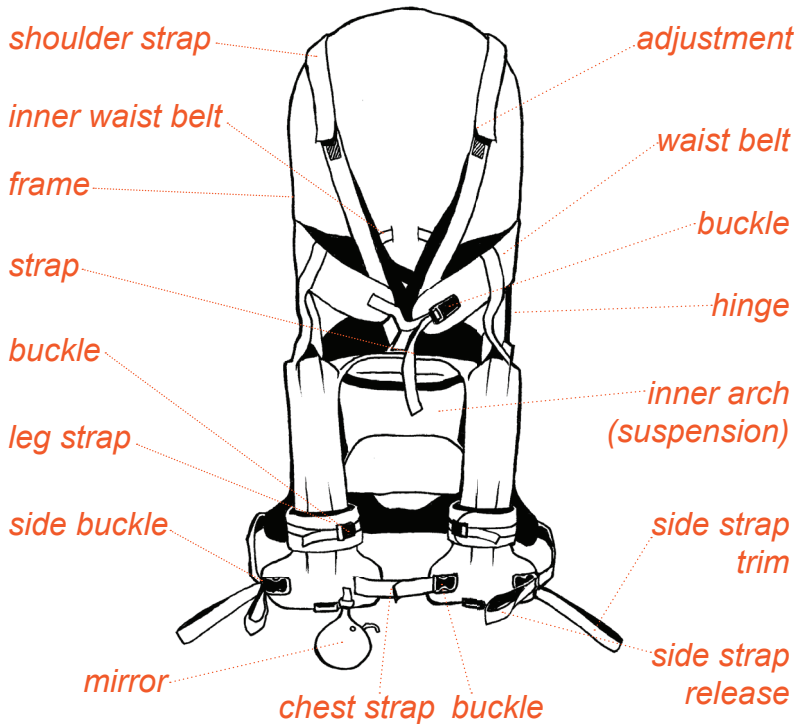

MiniMeis G4 Components (back)

*shoulder strap
attachment loop*

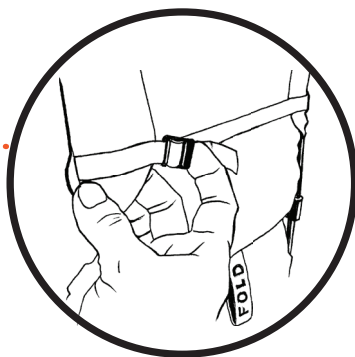
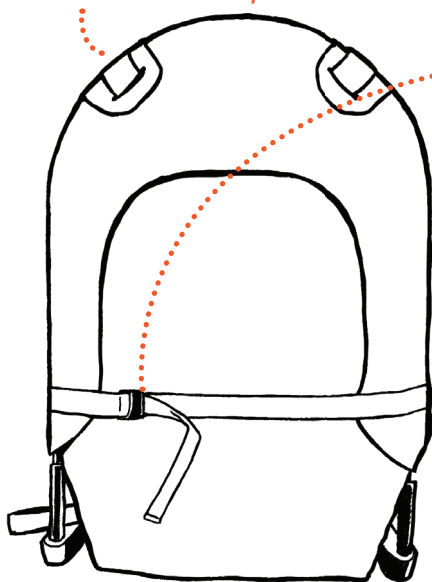

*adjustable strap
for seat expansion.
Adjust according
to the size of your
child.*

Prepare For Use

ALWAYS inspect carrier before use. Check for ripped seams, torn straps or fabric and damaged hardware. If found, stop using carrier.

1. Remove the side straps holding the MiniMeis in the folded position.
2. Rotate the back support upward. Both sides of the back support should slide into the lower portion of the frame.
3. Make sure both sides of the frame are secure before each use.

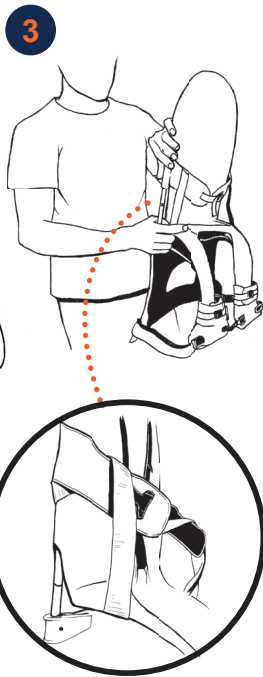

Extra support for children 6 – 10 months

Ensure that the child is safely positioned in the carrier according to the instructions below.

If your child needs extra support, use the MiniMeis with the 9-point-harness as described below.

1. Lay your MiniMeis on a flat surface. Secure the child in the seat and fasten the shoulder strap in one of two loops at the top.
2. Fasten the waist belt and the leg straps.
3. Place your hands through the straps on each side and grab your child around the waist (as you would normally do to lift it up on to your shoulders)
4. Lift the child up onto your shoulders.
5. Attach the MiniMeis by fastening the straps in front and on each side.

Always check all buckles snaps, straps and adjustments are secure.

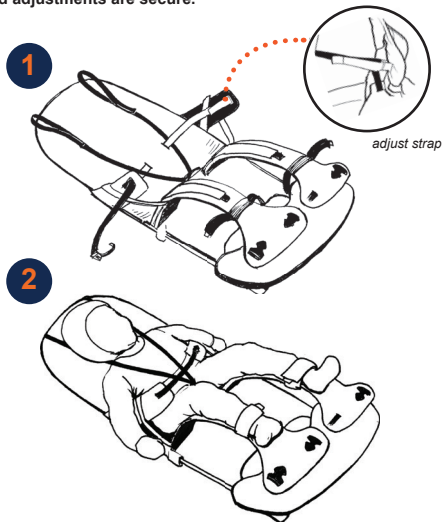

For children over 10 months of age

Ensure that the child is safely positioned in the carrier according to the instructions below.

1. Place the MiniMeis on your shoulders. Connect the chest and side buckles.
2. Lift the child up in the carrier and place it all the way into the seat. It should not be seated between the carrier and the neck. Child must face forward.
3. Immediately fasten the waist belt around your child and tighten it firmly.
4. Fasten the leg straps around the legs and secure with buckle.
5. Secure the child with the shoulderstrap through the loop on the crotch and through the two loops on the back.

Always check all buckles snap, straps and adjustments are secure.

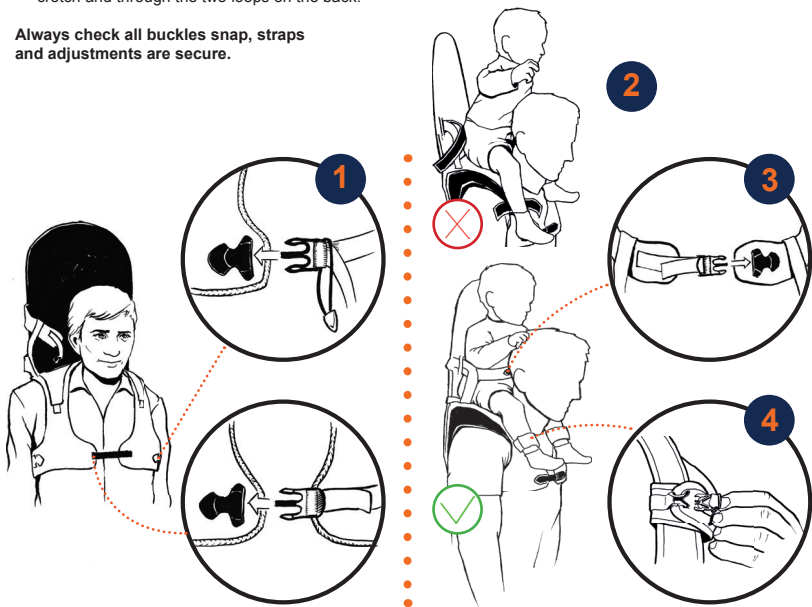



Tip 1

Correct sitting position: If you are not able to lift your child fully into the seat at first try, use the child's legs to push it properly into the seat. Immediately fasten and tighten waistbelt. Check with mirror that the child is sitting properly into the seat, displaying a curved setback.



Tip 2

ADJUSTMENT FOR WOMEN:

If the carrier is still not comfortable over the chest area after adjusting the straps, then release the front strap

The two side straps **MUST** remain connected and tight

Adjustment for all.

Tip 3

Use some time to adjust all straps so the carrier fully suits your body. If the MiniMeis is tilting a bit backwards, loosen the chest strap and tighten the side straps.

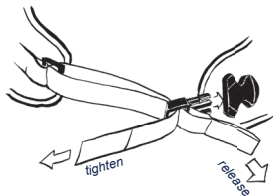

How To Fold / Store MiniMeis

1. Grab the strap marked "FOLD" with one hand.
2. Use your other hand to pull top of the frame. The back support section will slide out of the lower section.
3. Fold the back support section down.
4. Connect the waist belt to hold your MiniMeis in the folded position.
5. Attach the side straps over the folded hinges in criss cross pattern to keep the MiniMeis in the folded position.
Use the buckle to tight the fold.



Shoulder strap

Important! Please put the shoulder strap in the pocket and seal it with the zipper before you place the child in the MiniMeis.

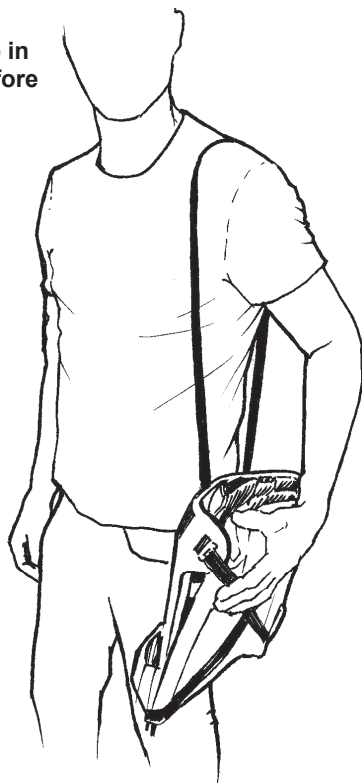

Washing instructions

Improper care will void any and all warranties.

MINIMEIS®

child carrier

100% Polyester Fiber



Replacement Parts

Only use accessories and replacement parts from Authorized Dealers or MiniMeis AS.

Warranty

1 year

MiniMeis AS

Øvre gate 7

N-0551 Oslo

Norway

Org. nr: 912 456 951

MiniMeis.com